

Amphenol® RF SMA and SMB Connectors

A

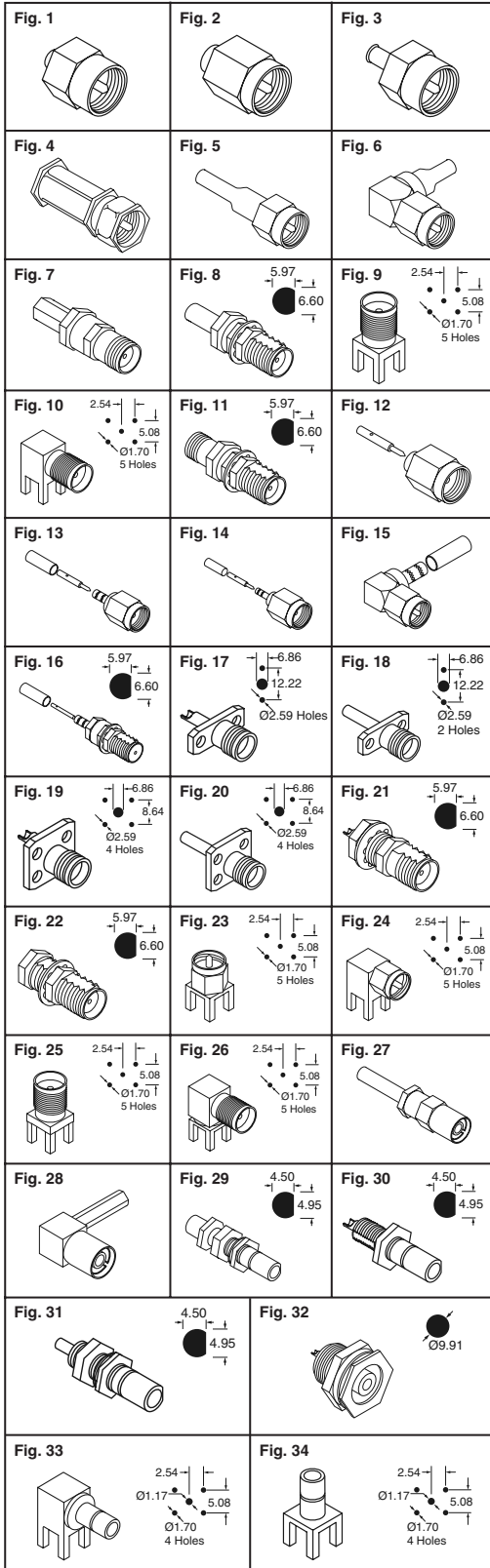

SMA Coaxial Connectors

Fig.	Description	Cable Group RG/U	Body Plating	Cable Attachment Outer / Inner	Digi-Key Part No.	Pricing			Amphenol Part No.
						1	25	100	
1	Plug, Straight	.085" (2.2mm) RG-405 (M17/133)	Gold	Solder	ARF1184-ND	6.09	105.86	368.22	901-9723
2	Plug, Straight	.141" (3.6mm) RG-402 (M17/130)	Gold	Solder	ARF1185-ND	5.62	97.75	340.00	901-9808
3	Plug, Straight	.085" (2.2mm) RG-405 (M17/133)	Gold	Solder	ARF1186-ND	6.47	112.50	391.58	901-9805-HP
4	Plug, Straight Plug, Straight	55, 58, 141, 142, 223 174, 316	Gold Gold	Clamp Clamp	ARF1187-ND* ARF1188-ND*	70.16 40.68	1220.02 842.75	4243.13 3003.17	901-103 901-128-11
5	Plug, Straight Plug, Straight Plug, Straight Plug, Straight Plug, Straight	55B, 142B, 223, 400 55B, 142B, 223, 400 174, 179, 187, 188, 316 174, 179, 187, 188, 316 Dbl. Braid RG-188, 316	Gold Passivated Gold Passivated	Crimp Crimp Crimp Crimp	ARF1189-ND ARF1190-ND ARF1191-ND ARF1192-ND ARF1193-ND	9.74 8.88 7.21 6.44 7.31	169.54 154.59 125.25 112.00	589.39 537.15 436.00 389.00 442.00	901-9511-1 901-9511-1SF 901-9511-3 901-9511-3SF 901-9511-12SF
6	Plug, Right Angle Plug, Right Angle Plug, Right Angle Plug, Right Angle Plug, Right Angle	55, 141, 142, 223 SF 142B, Times AA-2423 174, 179, 187, 188, 316 174, 179, 187, 188, 316 Double Braid RG-316	Gold Passivated Gold Passivated Gold	Crimp Crimp Crimp Crimp Crimp	ARF1194-ND ARF1195-ND ARF1196-ND ARF1197-ND ARF1198-ND	12.45 12.95 12.52 8.42 12.96	216.60 225.03 217.62 146.25 225.27	753.77 783.20 757.86 509.00 784.24	901-9531-1 901-9531-1SF 901-9531-3 901-9531-3SF 901-9531-12
7	Jacks Jacks	174, 179, 187, 188, 316 174, 179, 187, 188, 316	Gold Passivated	Crimp Crimp	ARF1200-ND ARF1201-ND	51.66 41.63	861.00 768.93	2579.26 2674.51	901-9602-3 901-9602-3SF
8	Jacks, Bulkhead Jacks, Bulkhead Jacks, Bulkhead	55, 142, 223, 400 174, 179, 187, 188, 316 174, 179, 187, 188, 316	Passivated Gold Passivated	Crimp Crimp Crimp	ARF1202-ND ARF1203-ND ARF1204-ND	21.76 17.16 14.34	378.50 298.53 249.25	1316.00 1038.50 884.40	901-9610-1SF 901-9610-3 901-9610-3SF
9	Jacks, Printed Circuit Board, Panel	—	Gold	—	ARF1205-ND	8.49	147.75	514.00	901-144
10	Jacks, Printed Circuit Board, Angle	—	Gold	—	ARF1206-ND	10.71	186.25	648.00	901-143
11	Adapters, Bulkhead Jack- Jack, Front or Rear Mt.	—	Gold	—	ARF1207-ND	13.82	240.25	836.00	901-9209A
11	Adapters, Bulkhead Jack- Jack, Front or Rear Mt.	—	Passivated	—	ARF1208-ND	14.64	244.00	731.00	901-9209-ASF

* Safety wire holes.

SMA Brass Coaxial Connectors

Fig.	Description	Cable Group RG/U	Body Plating	Cable Attachment Outer / Inner	Digi-Key Part No.	Pricing			Amphenol Part No.
						1	25	100	
12	Plug, Straight Plug, Straight	.141" (3.6mm) S/R .085" (2.16mm) S/R	Gold Gold	Solder Solder	ARFX1209-ND ARFX1210-ND	3.99 3.15	66.50 52.50	199.00 158.00	901-9868-RFX 901-9867-RFX
13	Plug, Straight Plug, Straight Plug, Straight	58 141, 223 58	Gold Gold Nickel	Crimp Crimp Crimp	ARFX1211-ND ARFX1212-ND ARFX1213-ND	5.23 5.23 5.29	86.50 91.00 56.50	301.00 316.00 170.00	901-9870 901-9871 901-9876-RFX
14	Plug, Straight Plug, Straight	174, 188, 316 174, 188, 316	Nickel Gold	Crimp Crimp	ARFX1214-ND ARFX1215-ND	3.39 4.93	56.50 85.75	170.00 298.00	901-9877-RFX 901-9916
15	Plug, Right Angle Plug, Right Angle Plug, Right Angle Plug, Right Angle	174, 188, 316 58 141, 223 58	Gold Gold Gold Nickel	Crimp Crimp Crimp Crimp	ARFX1216-ND ARFX1217-ND ARFX1218-ND ARFX1219-ND	8.28 8.79 7.43 5.08	144.00 153.00 129.25 88.49	501.00 532.00 449.00 307.57	901-9872 901-9873 901-9874 901-9880-RFX
16	Bulkhead Jack Bulkhead Jack	174, 188, 316 174, 188, 316	Gold Nickel	Crimp Crimp	ARFX1221-ND ARFX1222-ND	7.43 6.75	129.25 117.24	449.00 408.59	901-9875 901-9879-RFX
17	Panel Receptacle, Jack	—	Nickel	—	ARFX1223-ND	5.58	93.00	279.00	901-9893-RFX
18	Panel Receptacle, Jack	—	Nickel	—	ARFX1224-ND	7.83	130.50	391.00	901-9891-RFX
19	Panel Receptacle, Jack	—	Nickel	—	ARFX1225-ND	5.79	96.50	337.75	901-9892-RFX
20	Panel Receptacle, Jack	—	Nickel	—	ARFX1226-ND	8.37	139.50	418.00	901-9887-RFX
21	Bulkhead Recep., Front Mt.	—	Nickel	—	ARFX1227-ND	4.80	80.00	240.00	901-9889-RFX
22	Bulkhead Recep., Rear Mt.	—	Nickel	—	ARFX1228-ND	4.80	80.00	240.00	901-9890-RFX
23	Plug Straight PCB Recep.	—	Gold	—	ARFX1229-ND	3.98	69.27	241.35	901-9895-RFX
24	Plug Rt. Angle PCB Recep.	—	Gold	—	ARFX1230-ND	8.31	138.50	415.00	901-9894-RFX
25	Receptacle, Straight PCB	—	Gold	—	ARFX1231-ND	3.58	62.25	217.00	901-144-8RFX
26	Recep., Right Angle PCB	—	Gold	—	ARFX1232-ND	5.52	96.00	334.00	901-143-6RFX

SMB Coaxial Connectors

Fig.	Description	Cable Group RG/U	Plating	Cable Attachment Outer / Inner	Digi-Key Part No.	Pricing			Amphenol Part No.
						1	25	100	
27	Plug, Straight	RG-174, 179, 187, 188, 316	Nickel	Crimp	ARF1233-ND	5.56	96.75	337.00	903-370P-51S
28	Plug, Right Angle Plug, Right Angle Plug, Right Angle Plug, Right Angle	RG-174, 179, 187, 188, 316 RG-174, 179, 187, 188, 316 RG-178, 196 RG-178, 196	Nickel Gold Gold Nickel	Crimp Crimp Crimp Crimp	ARF1235-ND ARF1245-ND ARF1236-ND ARF1237-ND	4.90 7.03 5.32 3.82	85.00 169.31 119.81 77.25	295.71 588.66 416.35 268.00	903-367P-51A2 903-289P-51A 903-291P-51A1 903-368P-51A1
29	Bulkhead Jack Bulkhead Jack	RG-174, 188A, 316 Dbl. Shield 316	Gold Gold	Crimp Crimp	ARF1238-ND ARF1239-ND	6.04 6.53	105.00 113.51	365.00 394.60	903-505J-51S 903-505J-51S1
Fig.	Description			Plating	Digi-Key Part No.	Pricing			Amphenol Part No.
30	Bulkhead, Recept. Front Mount Solder Cup Terminal			Gold	ARF1240-ND	5.21	90.50	315.00	903-406J-51R
31	Bulkhead, Recept. Front Mount Blunt Post Terminal			Gold	ARF1241-ND	4.28	74.50	259.00	903-402J-51R
32	Bulkhead Jack, Recept. Recessed, Solder Cup Term.			Gold	ARF1242-ND	13.04	226.76	788.11	903-407J-51R
33	Jack Right Angle			Tin Lead (Body & Legs) Gold (Interface & Term.)	ARF1243-ND	5.92	103.00	358.00	903-373J-51A
34	Jack Straight			Gold	ARF1244-ND	3.54	61.75	214.00	903-499J-51P2

More Product Available Online: www.digikey.com

Toll-Free: 1-800-344-4539 • Phone: 218-681-6674 • Fax: 218-681-3380

(7061) 279